

NO	DESCRIPTION	Q'TY	REMARKS	NO	DESCRIPTION	Q'TY	REMARKS
01-00	LEVER ASS'Y	1		39-00	BOTTOM HOOK ASS'Y	1	
01-08	RUBBER GRIP	1		39-01	BOTTOM FRAME	2	
01-09	NAME PLATE	1		39-02	AXLE	1	
03-00	CHANGE PAWL	1		39-03	SHEAVE	1	
04-00	PUSH PIN	1		39-04	NEEDLE BEARING	2	
05-00	PUSH SPRING	1		39-05	HEX BOLT	3	M10x35
06-00	BOLT SPRING WASHER	1	M6x15	40-00	U NUT	1	M10
07-00	LEVER COVER ASS'Y	1		41-00	COTTER PIN	1	
08-00	U NUT	2	M8	42-00	SLOTTED NUT	1	M12
09-00	PAWL	2		43-00	TOP HOOK PIN	1	
10-00	PAWL SPRING	2		44-00	U NUT	1	M12
11-00	SNAP RING	2	E-12	45-00	HANGER PIN	1	
12-00	CLUTCH ASS'Y	1	OPTION	46-00	GRIP RING COVER	1	
12-05	CHANGE GEAR	1		47-00	MACHINE SCREW	2	M3x5
13-00	COLLAR	1					
14-00	SNAP RING	1	T5304-62				
15-00	HUB	1					
16-00	RATCHET GEAR	1					
17-00	BRAKE COVER	1					
18-00	DISC	2	ø64xø40.5x3.5				
19-00	COVER BUSH	1					
20-00	SPRING RECEIVER	1					
21-00	SNAP RING	1	C-75				
22-00	CHAIN GUIDE	2					
23-00	STRIPPER	1					
24-00	LEVER SIDE PLATE ASS'Y	1					
25-00	TOP HOOK ASS'Y	1					
25-A1	HOOK ASS'Y	2					
25-S1	SAFETY LATCH SET	2					
25-03A	TOP FRAME A	1					
25-03B	TOP FRAME B	1					
25-10	HEX BOLT	2	M10x30				
25-11	HEX NUT	5	M10				
26-00	PINION SHAFT WASHER	1					
27-00	PINION SHAFT	1					
28-00	LOAD SHEAVE	1					
29-00	1ST GEAR	1					
30-00	2ND GEAR & 3RD GEAR	2					
31-00	GEAR SIDE PLATE ASS'Y	1					
32-00	GRIP RING	1					
33-00	SPRING	1					
33-01	RETURNING SPRING	1					
34-00	GEAR COVER ASS'Y	1					
35-00	U NUT	8	M10				
36-00	LOAD CHAIN	1					
37-00	END RING	1					
38-00	HOOK BOLT	1					

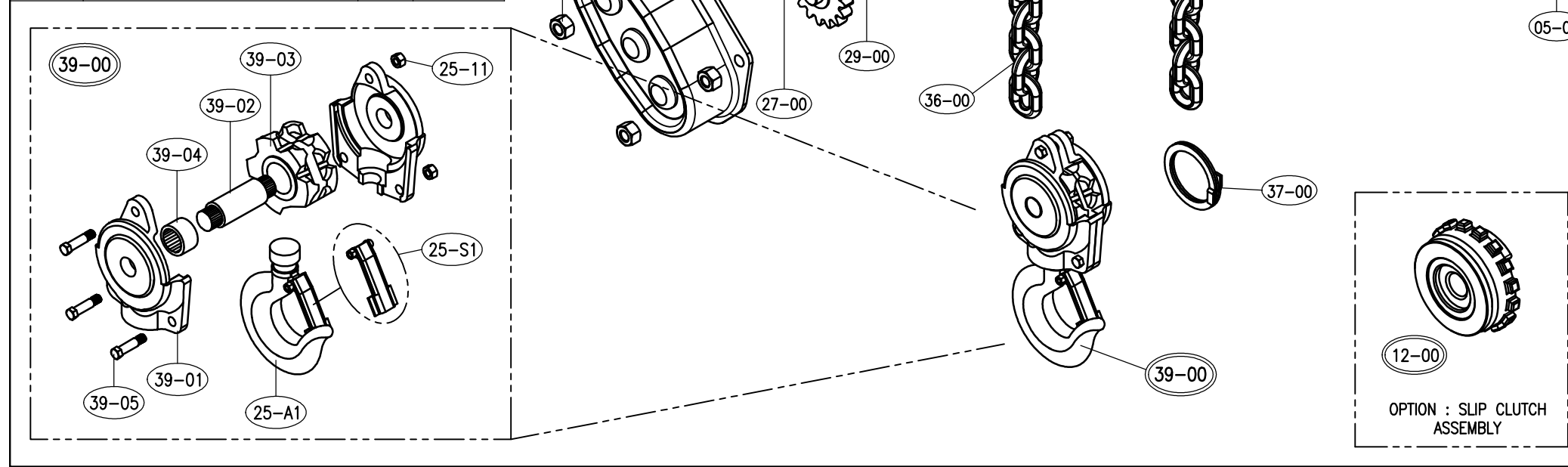

TITLE				NDM 6TON LEVER BLOCK		PROJECTION	
WORK NO				WORK NAME			
				SCALE		Q'TY	
				N S		1	
DRAWN	CHECKED	REVIEWED	APPROVED	DRAWING NO			
J.D	-	LEE. H.J	Y. K	NDM060WE01			
2019.10.31	-	2019.10.31	2019.10.31				
DAESAN INoTEC INC							